



Accelerating Uptake of Lung Cancer Screening

Through Public and Clinician Education and Engagement

ACS NLCRT Workshop | August 9, 2024 | Chicago, IL

Thank You ACS NLCRT Sponsors!

AstraZeneca 

 **MERCK**

Johnson & Johnson

Genentech
A Member of the Roche Group

REGENERON
science to medicine®

sanofi

 **Daiichi-Sankyo**

 **Bristol Myers Squibb**

 **Takeda**

ONCOLOGY



GILEAD

Creating Possible

AMGEN®

Additional thanks to...

AbbVie | Boehringer Ingelheim | Foundation Medicine

Guardant Health | Novocure | Roche

The ACS NLCRT, Member Organizations, and Partners are committed to the adoption of language, phrasing, and imagery that is person-first, judgment-free, and non-stigmatizing.

This shift in language takes time and dedicated effort, and slips happen, but it is an important component of creating a more supportive and empathic environment to reduce the burden of lung cancer.

We appreciate your effort!



Welcome to the ACS National Lung Cancer Roundtable

August 9, 2024

Dear Workshop Participants,

Welcome to the American Cancer Society National Lung Cancer Roundtable's (ACS NLCRT) workshop, *Accelerating Uptake of Lung Cancer Screening Through Public and Clinician Education and Engagement*. We hope your travels to Chicago were smooth, and that you've come ready to roll up your sleeves and work together!

Accelerating the uptake of lung cancer screening is a strategic priority of the ACS NLCRT. During our July 2022 Summit, *Accelerating Uptake of Lung Cancer Screening – A National Initiative*, participants identified critical challenges and barriers to lung cancer screening, and developed and prioritized strategies to build a comprehensive framework that would engage key partners with actionable recommendations. Effective messaging and appropriately focused outreach to patients, the public and clinicians were ranked among the highest priorities by Summit attendees as important strategies to accelerate uptake of lung cancer screening. Our goal today is to build on this groundwork for developing impactful communications and outreach approaches that will resonate with the needs of many crucial audiences to accelerate the uptake of lung cancer screening by:

- Promoting education and awareness through clinicians, health systems, community, and the public
- Identifying best practices in communicating and educating regarding lung cancer screening awareness
- Increasing clinician endorsement of lung cancer screening

The ACS NLCRT was founded from the roots of collaboration among professional societies and patient advocacy groups to work towards Medicare coverage for lung cancer screening after the USPSTF first recommended it in December 2013. Our strategic priority to accelerate uptake of lung cancer screening is multifaceted and engages the expertise and leadership of several ACS NLCRT task groups: Provider Engagement and Outreach, Early Detection Implementation Strategies, and Tobacco Treatment. The committees work to address the challenges that contribute to the low rates of lung cancer screening across the country.

Many of our initiatives—from the LungPLAN™, our return on investment modeling tool that helps sites build and expand their lung cancer screening and nodule management programs, to our partnership with the American College of Radiology, the Radiology Health Equity Coalition, GO2 for Lung Cancer, and the Veterans Health Administration to sponsor the 3rd annual National Lung Cancer Screening Day on November 9, 2024, and assisting champions at the local level build comprehensive coalitions to advance lung cancer priorities using our State-Based Initiatives Planning Tool, and soon to be released resources (*Best Practice Guide for Building Lung Cancer Early Detection Programs*, *STEPS For Increasing Lung Cancer Screening Rates: A Manual for Primary Care Practices*, and *Lung Cancer Stigma – Communications Assessment Tool*)—are efforts to drive eligible individuals to be screened, and to elevate the national conversation around lung cancer screening. Together, the ACS NLCRT catalyzes action through our member organizations, volunteers, and sponsors by building and strengthening innovative, evidence-based solutions to the many challenges we face in our efforts to create more lung cancer survivors.

We are grateful to the American Cancer Society and our corporate partners who make this critical work possible. AbbVie, Amgen, AstraZeneca, Boehringer Ingelheim, Bristol Myers Squibb, Daiichi-Sankyo, Foundation Medicine, Genentech, Gilead, Guardant Health, Johnson & Johnson, Merck, Novocure, Regeneron, Roche, Sanofi, and Takeda all share the passion and conviction that we can make a difference in the lives of individuals affected by lung cancer when we collaborate, bringing our unique strengths and perspectives to find solutions to complex problems.

Thank you for being here today, sharing our sense of urgency to accelerate the uptake of lung cancer screening and changing the face of lung cancer through early detection for future generations!



Ella Kazerooni, MD, MS
University of Michigan
Chair, ACS NLCRT



Thomas Houston, MD
American Academy of
Family Physicians



Jessica Olson, PhD
Medical College of Wisconsin

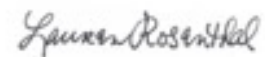

Lauren Rosenthal, MPH
ACS NLCRT



Jan Eberth, PhD
Drexel University



Anita Kinney, PhD, RN
Rutgers University



Jennifer Redmond Knight, DrPH
University of Kentucky

Meeting Agenda

6:30–7:30 AM | Networking Breakfast

7:30–8:00 AM | GENERAL SESSION – Opening Session

Welcome and Introduction

Speakers

- Ella Kazerooni, MD, MS
Chair, ACS NLCRT
University of Michigan
 - John Anderson
Patient Advocate
 - Erin Hester, PhD
University of Kentucky
Just Do It: Lesson from Nike to Accelerate Lung Cancer Screening
-

8:05–8:40 AM | GENERAL SESSION – Session 1

Clinician Outreach, Education & Engagement

Charge: To engage physicians, advanced practice providers, navigators, and tobacco treatment specialists to prioritize the uptake of lung cancer screening.

Moderator

- Thomas Houston, MD
American Academy of Family Physicians

Speakers

- Jamie Studts, PhD
University of Colorado
Clinician Engagement and Lung Cancer Screening: What Worked in Kentucky
 - Thomas Varghese, Jr., MD, MS, MBA
University of Utah
Podcasts – The Modern Art of Storytelling
 - Brendon Stiles, MD
Albert Einstein College of Medicine and Montefiore Medical Center
Let's Get Social: Connecting with Clinicians about Lung Cancer Screening
 - Ronald Myers, DSW, PhD
Thomas Jefferson University
Mid-Atlantic Provider and Patient Support (MAPPS) Study: Tools for Engagement
-

8:45–9:20 AM | GENERAL SESSION – Session 2

Health Systems Outreach, Education & Engagement

Charge: To integrate and optimize/prioritize best practices in delivery of high-quality lung cancer screening.

Moderator

- Anita Kinney, PhD, RN
Rutgers Cancer Institute of New Jersey

Speakers

- Michael Pignone, MD, MPH
Duke Cancer Institute
Implementing Lung Cancer Screening in FQHCs
- Renda Wiener, MD, MPH
VA Boston Healthcare System
Best Practices in Delivery of High-Quality Lung Cancer Screening in the Veterans Health Administration
- Donald Noblett, MPH
Inspira Health
Inspira Health's Impact in Southern New Jersey
- Lawrence An, MD
University of Michigan
Addressing the Impact of COVID-19 on Cancer Screening in a State FQHC Network

9:25–10:00 AM | GENERAL SESSION – Session 3

Community Outreach, Education & Engagement

Charge: To facilitate engagement between health systems, community organizations, health departments, and comprehensive cancer coalitions to promote lung cancer screening.

Moderator

- Jennifer Redmond Knight, DrPH
University of Kentucky

Speakers

- Nikki Hayes, MPH
Centers for Disease Control and Prevention
State-Based Coalitions – Engagement Best Practices Towards Comprehensive Cancer Control
 - Loretta Erhunmwunsee, MD
City of Hope Comprehensive Cancer Center
Partnering with FQHCs to Implement Lung Cancer Screening Programs
 - Ryan Nguyen, DO
University of Illinois
Building Bridges to Early Detection: Transforming Perceptions and Practices in Lung Cancer Screening through Community Engagement
 - Lisa Carter-Bawa, PhD, APRN, ANP-C
Hackensack Meridian Health
Leveraging Social Media to Increase Awareness, Knowledge, and Uptake of Lung Cancer Screening
-

10:00–10:30 AM | Networking Break

10:30–11:15 AM | GENERAL SESSION – Session 4

Public Outreach, Education & Engagement

Charge: To harness the power of diverse marketing and media communications tools to increase public awareness and education about the importance of lung cancer screening.

Moderator

- Jessica Olson, PhD, MPH
Medical College of Wisconsin

Speakers

- Jeri Ramos, MA
American Cancer Society
Crucial Catch Campaign - Leveraging the Power of Sports to Fuel Change
- Linda Aragon, MPH
Los Angeles County Department of Public Health
Never Stop Quitting Campaign
- Debra Dyer, MD
National Jewish Health
National Lung Cancer Screening Day – What, Why, and How?
- Chi-Fu Jeffrey Yang, MD
Massachusetts General Hospital
Plus One Campaign
- Margaret Harrison, MA
Genentech
Screen Your Lungs Campaign
- Deborah Brown, MS
American Lung Association
Saved by the Scan Campaign
- Scout, PhD
National LGBTQI+ Cancer Network
Breath Out

11:15–11:20 AM | Introduction of Breakout Groups Process

Breakout Groups #1 Overview

Speaker

- Jennifer Redmond Knight, DrPH
University of Kentucky

11:20–11:25 AM | Travel to Breakout Group Rooms

11:25 AM–12:25 PM | BREAKOUT SESSION 1

Review Main Two Strategies per Audience and Brainstorm Tactics to Support the Strategies

Group 1: Clinician Outreach, Education & Engagement

- Co-Leads**
- Ella Kazerooni, MD, MS
 - Brendon Stiles, MD

Group 2: Health Systems Outreach, Education & Engagement

- Co-Leads**
- Jan Eberth, PhD
 - Anita Kinney, PhD, RN

Group 3: Community Outreach, Education & Engagement

- Co-Leads**
- Jennifer Redmond Knight, DrPH
 - Loretta Erhunmwunsee, MD

Group 4: Public Outreach, Education & Engagement

- Co-Leads**
- Jessica Olson, PhD, MPH
 - Scout, PhD
-

12:25–1:15 PM | Networking Lunch

1:15–1:45 PM | All Attendee Report Out & Discussion

Breakout Groups #1

- Moderator**
- Thomas Houston, MD
American Academy of Family Physicians

Group 1: Clinician Outreach, Education & Engagement

- Co-Leads**
- Ella Kazerooni, MD, MS
 - Brendon Stiles, MD

Group 2: Health Systems Outreach, Education & Engagement

- Co-Leads**
- Jan Eberth, PhD
 - Anita Kinney, PhD, RN

Group 3: Community Outreach, Education & Engagement

- Co-Leads**
- Jennifer Redmond Knight, DrPH
 - Loretta Erhunmwunsee, MD

Group 4: Public Outreach, Education & Engagement

- Co-Leads**
- Jessica Olson, PhD, MPH
 - Scout, PhD
-

1:45–1:50 PM | Introduction of Breakout Groups Process

Breakout Groups #2 Overview

Speaker

- Jennifer Redmond Knight, DrPH
University of Kentucky
-

1:50–1:55 PM | Travel to Breakout Group Rooms

1:55–2:45 PM | BREAKOUT SESSION 2

Refine Tactics, Assess Feasibility, and Prioritization of Top 5 Tactics per Strategy

Group 1: Clinician Outreach, Education & Engagement

- Co-Leads**
- Ella Kazerooni, MD, MS
 - Brendon Stiles, MD

Group 2: Health Systems Outreach, Education & Engagement

- Co-Leads**
- Jan Eberth, PhD
 - Anita Kinney, PhD, RN

Group 3: Community Outreach, Education & Engagement

- Co-Leads**
- Jennifer Redmond Knight, DrPH
 - Loretta Erhunmwunsee, MD

Group 4: Public Outreach, Education & Engagement

- Co-Leads**
- Jessica Olson, PhD, MPH
 - Scout, PhD
-

2:45–3:10 PM | Networking Break

3:10–3:40 PM | All Attendee Report Out & Discussion

Breakout Groups #2

- Moderator** • Thomas Houston, MD
American Academy of Family Physicians

Group 1: Clinician Outreach, Education & Engagement

- Co-Leads** • Ella Kazerooni, MD, MS
• Brendon Stiles, MD

Group 2: Health Systems Outreach, Education & Engagement

- Co-Leads** • Jan Eberth, PhD
• Anita Kinney, PhD, RN

Group 3: Community Outreach, Education & Engagement

- Co-Leads** • Jennifer Redmond Knight, DrPH
• Loretta Erhunmwunsee, MD

Group 4: Public Outreach, Education & Engagement

- Co-Leads** • Jessica Olson, PhD, MPH
• Scout, PhD
-

3:40–4:10 PM | GENERAL SESSION – FEEDBACK

All Attendee Feedback via Slido

- Moderator** • Jennifer Redmond Knight, DrPH
University of Kentucky
-

4:10–4:15 PM | CLOSING SESSION

Closing Remarks, Next Steps & Thank You

- Speaker** • Ella Kazerooni, MD, MS
Chair, ACS NLCRT
University of Michigan
-

SLIDO

We will be using Slido, an interactive tool that will allow everyone a voice in the prioritization of future work. To use Slido: Scan the QR code, which will take you to the ACS NLCRT workshop poll.



Breakout Sessions

Clinician Education & Engagement

Charge: To engage physicians, advanced practice providers, navigators, and tobacco treatment specialists to prioritize the uptake of lung cancer screening.

Strategies:

- Implement the newly developed LCS HEDIS quality measure.
- Improve primary care team education on LCS focused on those who serve populations who are medically underserved.

ACS Facilitator

- Molly Black, MPH

Co-Leads

- Ella Kazerooni, MD, MS
 - Brendon Stiles, MD
-

Health Systems Education & Engagement

Charge: To integrate and optimize/prioritize best practices in delivery of high-quality lung cancer screening.

Strategies:

- Create a value proposition for why health systems should invest in LCS programs.
- Empower health systems to use social determinants of health (SDOH) data proactively and meaningfully to identify and address disparities in LCS.

ACS Facilitator

- Megan Burns

Co-Leads

- Jan Eberth, PhD
 - Anita Kinney, PhD, RN
-

Community Education & Engagement

Charge: To facilitate engagement between health systems, community organizations, health departments, and comprehensive cancer coalitions to promote lung cancer screening.

Strategies:

- Develop a community engagement and outreach framework for LCS that prioritizes health equity.
- Implement community led LCS outreach efforts that include community representation to build a sense of hope, empowerment, and respect for the community.

ACS Facilitator

- Katie Bathje, MA

Co-Leads

- Jennifer Redmond Knight, DrPH
- Loretta Erhunmwunsee, MD

Public Education & Engagement

Charge: To harness the power of diverse marketing and media communications tools to increase public awareness and education about the importance of lung cancer screening.

Strategies:

- Increase awareness and eliminate knowledge gaps among those who are currently eligible for LCS.
- Implement a robust national public awareness campaign on LCS with local feel and impact (i.e., community champions, trusted voices, survivors/patient advocates, etc.).

ACS Facilitator

- Kaitlyn Keen, MPH

Co-Leads

- Jessica Olson, PhD, MPH
 - Scout, PhD
-

Breakout Assignments

Clinician Education & Engagement



Ella Kazerooni

Professor, Department of Radiology
University of Michigan

ACS Facilitator:

John Anderson
Vickie Beckler
Linda Dowling
Heather Bittner Fagan
Jill Feldman
Vickie Fowler

Molly Black

Mary Gilarski
Eric Hart
Louise Henderson
Thomas Houston
Hasmeena Kathuria
Jennifer Lewis

Brendon Stiles

Professor, Cardiothoracic Surgery
Montefiore Health

Sabrina Moffat
Ronald Myers
Pierre Onda
Elyse Park
Albert Rizzo
Jamie Studts

Thomas Varghese, Jr.
Robert Volk
Richard Wender
Patricia Wilson
Julie Wood

Health Systems Education & Engagement



Anita Kinney

Professor, Biostatistics and Epidemiology
Rutgers Cancer Institute of New Jersey

ACS Facilitator:

Melinda Aldrich
Lawrence An
Angela Barry
Andrea Borondy Kitts
Judith Burseson
MacKenzie Church

Megan Burns

Grant Greenberg
Margaret (Meg) Harrison
Teri Hill
Korey Hofmann
Neville Irani
Christopher Martin

Jan Eberth

Director, Rural & Minority Health Research Center
Drexel University

Peter Mazzone
Timothy Merchant
Donald Noblett
Michael Pignone
Mary Reid
Lori Sakoda

Lecia Sequist
Jody Steinhardt
Michael Tobin
Renda Weiner
Denise Wojcik

Community Education & Engagement



Loretta Erhunmwunsee

Associate Professor, Department of Surgery
City of Hope Comprehensive Cancer Center

ACS Facilitator:

Lisa Carter-Bawa
Nikki Hayes
Erin Hester
Dwana (Dee) Calhoun
Gissoo DeCotiis

Katie Bathje

Terri Ann DiJulio
Francesca Duncan
Michelle Futrell
Brittany Lovely
Timothy Mullett

Jennifer Redmond Knight

Assistant Professor, Department of Health
Management and Policy
University of Kentucky

Ryan Nguyen
Alexandra Potter
Dorothy Rhoades
M. Patricia Rivera
Liora Sahar

Sarah Shafir
Shunaiber Tauhid
Jeffrey Velotta
Andrew White
Matthew Zoerink

Public Education & Engagement



Jessican Olson

Assistant Professor, Community Health
Medical College of Wisconsin

ACS Facilitator:

Linda Aragon
Carla Brathwaite
Deborah Brown
Hannah Burson
Stefanie Chua

Kaitlyn Keen

Debra Dyer
Karl Lobo
Eugene Manley
Morgan Miller
Heidi Nafman-Onda

Scout

Executive Director
National LGBTQ+ Cancer Network

Eduardo Nunez
Elridge Proctor
Jeri Ramos
Susan Ruscheinsky
Keith Singer

Nichelle Stigger
Amy Stone
Britta Vaughan
Chi-Fu Jeffrey Yang

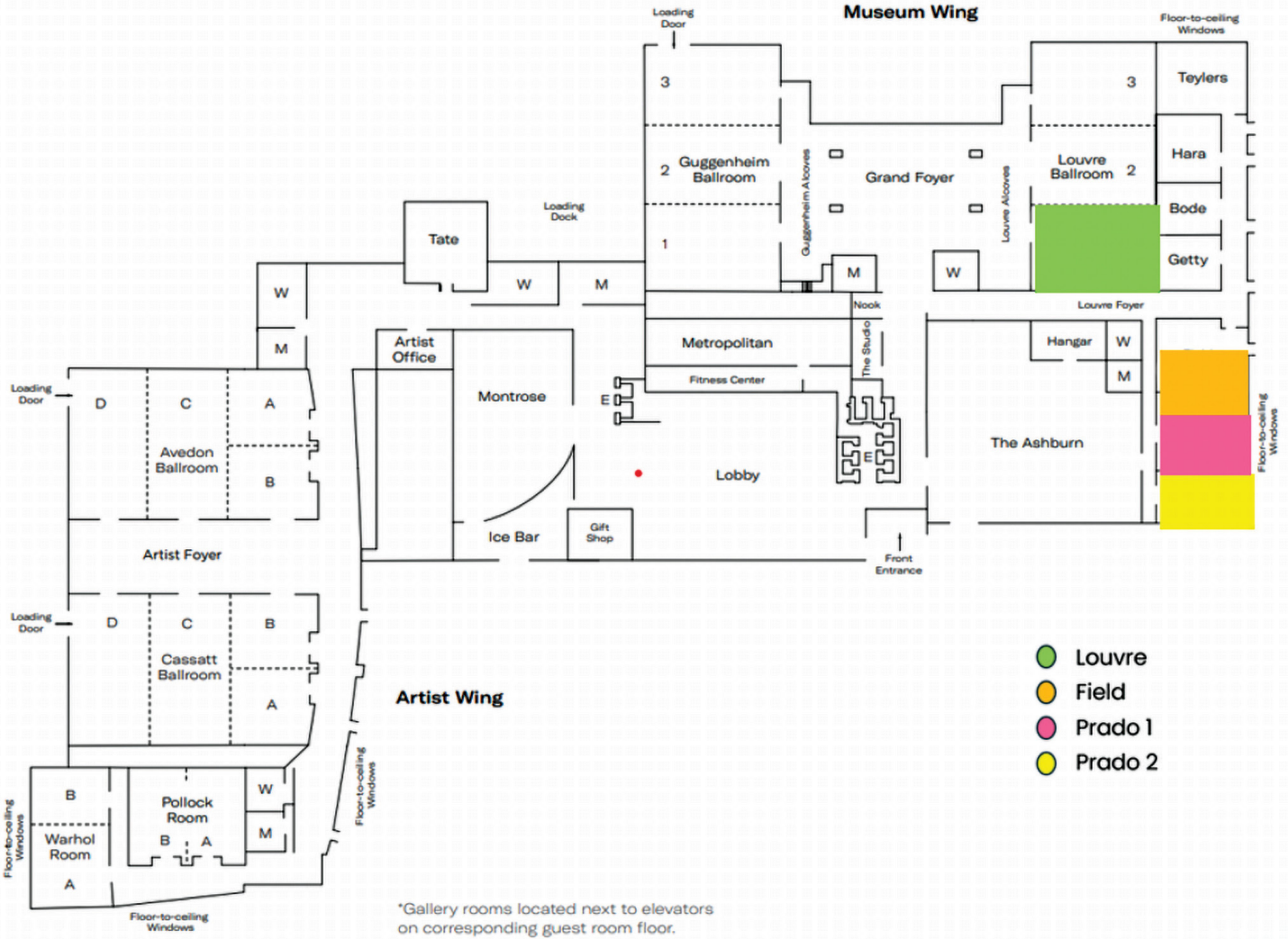

Speaker, Facilitator and Moderator Biographies



Lawrence An, MD

University of Michigan

Dr. An is particularly interested in exploring the use of remote monitoring and sensors to improve our understanding of patients' experiences, the use of mobile health and social media applications to improve patient/caregiver communication, and the application of novel engineering and computer science techniques to improve personalization of health communications. He has also worked extensively in the areas of clinical guideline implementation, quality improvement, and health systems change. Dr. An directs the Center for Health Communications Research (CHCR) at U-M.



John Anderson

Patient Advocate

In August of 2022, my general practitioner referred me to the Kaiser lung cancer screening program for high-risk people. After attending a video call to learn more about the CT scan process, I immediately signed up for the program. My first CT scan came up clear. One year later, I had my follow-up scan, which showed an area of my lower right lung that was suspected as cancer. Dr. Jeffrey Velotta, my Thoracic Surgeon, helped decide on treatment. Removal of the right lower lobe of my lung would be a curative procedure to remove the risk entirely. I agreed and prepared for the surgery.

The surgery biopsies showed that I did have cancer. With the removal of the lower part of my lung, my diagnosis was stage 1 cancer. No follow-up treatment was necessary. I have since had a six-month CT scan, which came up negative. I was up on my feet within a couple of weeks, but I still have some healing to do to get myself back to my full lung capacity.



Linda Aragon, MPH

Los Angeles County Department of Public Health

Ms. Aragon is the Director of Incident Management and Community Engagement in the Los Angeles County Department of Public Health's Division of Emergency Preparedness and Response. In a former position as the Director of Tobacco Control and Prevention, she developed a robust grassroots tobacco education campaign model that targeted local families and youth. This work led to the mobilization of local communities and the passage of more than 100 tobacco control policies in Los Angeles County aimed at decreasing youth access to tobacco products, reducing tobacco use, and increasing protection from secondhand smoke exposure including public areas such as public beaches and parks. Ms. Aragon earned a Master of Public Health in Health Education and Behavioral Science from the University of California, Los Angeles, and a Bachelor of Arts in Sociology from the University of California, San Diego. She has received multiple awards for her work in public health from the State of California, nonprofit agencies, and local government agencies including the prestigious Public Health Excellence Award for leadership.

**Deborah Brown, MS, CHES***American Lung Association*

Ms. Brown is the Chief Mission Officer for the American Lung Association. She holds a BS degree in Public Health from West Chester University and an MS degree in Health Education from St. Joseph's University. She has been a Certified Health Education Specialist since 1983.

Her past experiences have included working on advocacy issues in the areas of tobacco, asthma, school health, and healthcare. Passage of Delaware's Clean Indoor Air Act in 2002, the second comprehensive law in the country, is among her major accomplishments. Since then, she has been involved in the passage of the Pennsylvania Clean Indoor Air law, anti-idling legislation, and numerous environmental campaigns at both the state and federal levels. She has served as the chairperson for coalitions and partnerships throughout the Mid-Atlantic Region.

**Lisa Carter-Bawa, PhD, MPH, APRN, ANP-C***Center for Discovery & Innovation at Hackensack Meridian Health*

Dr. Carter-Bawa (formerly Carter-Harris) is a behavioral scientist and nurse practitioner. She is the Director of the Cancer Prevention Precision Control Institute at the Center for Discovery & Innovation at Hackensack Meridian Health in New Jersey and the Director of Community Outreach & Engagement at the John Theurer Cancer Center. She is also a Co-Leader of the Cancer Prevention & Control Program and Co-Director of Community Outreach & Engagement in the Georgetown Lombardi Comprehensive Cancer Center Consortium.

Dr. Carter-Bawa's research focuses on the many factors that influence the decision-making process in lung cancer screening decisions as well as actual screening behavior. She has a particular passion for understanding how stigma influences the decision to screen, or not, for lung cancer. She has co-designed and developed tailored interventions that support lung screening awareness, decision-making and screening uptake with particular attention to addressing health equity in lung cancer screening. Her research has been funded by the National Cancer Institute, American Lung Association, and New Jersey Commission on Cancer.

She is a Fellow of the American Academy of Nursing and a Fellow of the Society of Behavioral Medicine, and she currently serves on the editorial boards of *Nursing Research*, *Health Psychology*, and the *Journal of the National Cancer Institute*. Dr. Carter-Bawa is the Chair of the Stigma & Nihilism Task Group of the ACS NLCRT. She has also served on the President's Cancer Panel as an invited member of the Lung Cancer Screening Task Group and the Scientific Panel on Surveillance of Shared Decision-Making for Lung Cancer Screening for the CDC as well as numerous academic and national committees aimed at improving cancer prevention, early detection and decreasing inequities in care.

**Debra Dyer, MD***National Jewish Health*

Dr. Dyer is a fellowship-trained cardiothoracic radiologist and Professor of Diagnostic Radiology at National Jewish Health, a chronic respiratory disease hospital in Denver Colorado. She has implemented numerous Quality Improvement initiatives including programs in radiation dose reduction, the appropriate utilization of imaging and lung nodule management. She was instrumental in the creation of the National Jewish Health Lung Nodule Registry for incidental lung nodules, the first of its kind in the United States.

With a special interest in Lung Cancer Screening CT, Dr. Dyer serves as the Medical Director of the Lung Cancer Screening Program at National Jewish Health. She is the Immediate Past Chair of the American College of Radiology Lung Cancer Screening Steering Committee. Dr. Dyer serves as a current Co-Chair of the Colorado Lung Cancer Task Force of the Colorado Cancer Coalition. She is the current Vice Chair of the Lung Cancer Early Detection Implementation Strategies Task Group of the ACS NLCRT.

**Jan Eberth, PhD***Drexel University*

Dr. Eberth is Professor and Chair of the Department of Health Management and Policy at Drexel University's Dornsife School of Public Health. She is also a full member of the Cancer Risk & Control Research Program at the Sidney Kimmel Cancer Center - Jefferson Health.

Dr. Eberth's research focuses on identifying social and structural barriers to accessing high-quality healthcare in the U.S., particularly among rural and minoritized populations. Most of her work focuses on disparities in early detection and treatment for commonly diagnosed cancers including lung, breast, and colorectal cancer. Current research projects include an assessment of lung cancer screening pathways among patients seen in primary care clinics in Philadelphia, creation of small area estimates of lung cancer screening eligibility and uptake rates from population-based survey data, and a quality improvement project to enhance lung cancer screening programs throughout the South and Appalachia.

She is a Fellow and past President of the American College of Epidemiology, Vice Chair of the Provider Engagement and Outreach Task Group of the ACS NLCRT, and a member of the Cancer Prevention and Control Research Network's Rural Cancer Workgroup.



Loretta Erhunmwunsee, MD

City of Hope Medical Center

Dr. Erhunmwunsee is an associate professor in both the division of thoracic surgery and the division of health equity at City of Hope Medical Center. She graduated from Harvard Medical School, magna cum laude, and completed both her general and thoracic surgery training at Duke University Medical Center in Durham, NC. As a board-certified cardiothoracic surgeon, she leads a research program that centers on investigating the impact of adverse multilevel social determinants of health (SDOH) and structural racism on lung cancer risk, biology, and screening behaviors.

Specifically, her research has found that various social and environmental determinants, including PM2.5 and neighborhood deprivation, have significant impact on the rate of aggressive lung tumor mutations and the risk of lung cancer development. She is funded by the NCI as well as foundations such as the Lung Cancer Research Foundation and the American Association of Thoracic Surgeons Foundation. She is currently the Vice Chair of the NCCN DEI Directors forum and co-led the 2023 NCCN Measuring and Addressing Health-Related Social Needs on Cancer Working Group. She aims to bring awareness to the impact of structural inequities on disparate health outcomes.



Margaret (Meg) Harrison, MA

Genentech, a Member of the Roche Group

The mission of Patient Advocacy Relations at Genentech is to advocate for equitable health outcomes through the power of patient-focused partnerships. In this role, Ms. Harrison builds and maintains relationships with national patient advocacy organizations in the lung, kidney, and autoimmune patient communities. She partners with these organizations to better understand the needs of patients and their caregivers, identify alignment, and address shared priorities.



Nikki Hayes, MPH

Centers for Disease Control and Prevention

Ms. Hayes has been with the CDC's Division of Cancer Prevention and Control (DCPC) in the agency's National Center for Chronic Disease Prevention and Health Promotion (NCCDPHP) since 2002. Before joining CDC, she was a Biologist in the National Institute of Dental and Craniofacial Research (NIDCR) at the National Institutes of Health (NIH), where she established and managed the Institute's DNA Sequencing Core Facility for more than 10 years.

Ms. Hayes is currently the Chief of the DCPC Comprehensive Cancer Control Branch and is responsible for the successful implementation of one of the agency's flagship, multi-million dollar, cancer prevention and control programs, the National Comprehensive Cancer Control Program (NCCCP). She also manages several other programs that focus on improving the quality of life of cancer survivors, particularly young breast cancer survivors and metastatic breast cancer patients; and advancing commercial tobacco use prevention and cancer prevention in populations experiencing tobacco- and cancer-related health disparities.

**Erin Hester, PhD***University of Kentucky*

Dr. Hester is an Assistant Professor at the University of Kentucky specializing in public interest communications. Her work focuses on influencing motivation, decision-making, and actions to improve the human condition. With expertise in persuasive writing, community engagement, and social marketing, she makes complex health and risk information accessible and actionable for diverse audiences. Dr. Hester has collaborated with numerous organizations to design strategic communication solutions for issues such as obesity prevention, opioid abatement, child sex trafficking, inclusive sustainability, and lung cancer screening.

**Thomas Houston, MD***American Academy of Family Physicians*

Dr. Houston is a graduate of the University of Mississippi School of Medicine. After a 10-year career in academic family medicine, he directed the American Medical Association's tobacco control and public health advocacy programs. From 2003 to 2005, he held the Jim Finks Chair in Health Promotion at LSU Health Sciences Center in New Orleans and was Professor of Public Health and Family Medicine. From 2005-2016, he worked at the McConnell Heart Health Center in Columbus and directed tobacco cessation and policy initiatives for OhioHealth. He is currently Adjunct Professor in the Department of Family Medicine at The Ohio State University. He is past president of the Ohio Academy of Family Physicians.

**Ella Kazerooni, MD, MS***University of Michigan*

Dr. Kazerooni is a Professor of Radiology & Internal Medicine, Associate Chair for Clinical Affairs & Director of Cardiothoracic Radiology at the University of Michigan / Michigan Medicine. Her work in clinical and translational research earned her the University of Michigan Medical School's prestigious Clinical and Health Services Researcher of the year award. She has given over 400 lectures, nearly 300 peer-reviewed manuscripts, 30 book chapters and 4 books.

Dr. Kazerooni is the vice Chair of the NCCN Lung Cancer Screening panel, chairs the ACR Committee on Lung Cancer Screening including the Lung-RADS committee, worked towards the ACR Designated Lung Cancer Screening program under the CT accreditation program, and co-chairs the ACR's Lung Cancer Screening Registry (LCSR). These efforts are focused on bringing quality lung cancer screening to high-risk individuals and reduce the mortality from the #1 cancer killer. Most recently, she was named the inaugural chair of the ACS NLCRT.



Anita Kinney, PhD, RN

Rutgers Cancer Institute of New Jersey

Dr. Kinney has been an actively funded investigator in cancer prevention and control for over 25 years with a focus on behavioral, ethical, social, and care delivery genetics research. Dr. Kinney's research goal is to understand variation in cancer risk; determinants of risk and outcomes; and to use this information to develop effective interventions that facilitate informed decision-making, positive changes in health behaviors, and guideline-concordant genomic care delivery that leads to better outcomes.

Dr. Kinney also has considerable experience leading and collaborating on large community-based and population-based randomized trials that have developed and implemented effective interventions to promote cancer risk assessment and screening in average-risk and high-risk populations, and appropriate translation of genetic discoveries into clinical practice.

As a principal investigator or co-investigator on numerous transdisciplinary studies, Dr. Kinney has led efforts that involved clinic-based and population-based recruitment, Internet-based and other types of interventions, biospecimen acquisition and analysis, multi-site NCORP cancer care delivery research studies involving recruitment of minorities and other underserved populations, that successfully achieved accrual and retention goals in diverse populations. To date, she has published over 140 peer-reviewed publications and provided mentoring and training to over 50 students, postdocs and junior faculty.



Ronald Myers, DSW, PhD

Thomas Jefferson University

Dr. Myers is a Professor and Director of the Division of Population Science in the Department of Medical Oncology of Thomas Jefferson University and is Director of the Center for Health Decisions in the Sidney Kimmel Cancer Center of Thomas Jefferson University. His areas of expertise include patient adherence to cancer screening, physician follow-up of abnormal cancer screening test results, preference-based tailored navigation, disparities in cancer prevention and control, and shared decision-making in cancer care.

Dr. Myers has led numerous studies of shared decision-making in genetic risk assessment, colorectal cancer screening, lung cancer screening, prostate cancer screening, multi-cancer early detection, lung cancer treatment, prostate cancer treatment, and clinical trials participation. He is currently PI on an NCI-funded R01 that is a multi-level implementation science study on lung cancer screening across four health systems.

**Ryan Nguyen, DO***University of Illinois Chicago*

Dr. Ryan Nguyen, DO is a thoracic medical oncologist and assistant professor of clinical medicine at the University of Illinois Chicago. His research focuses on community engagement in lung cancer screening, clinical trials, and precision oncology.

**Donald Noblett, MPH***Inspira Health*

Mr. Noblett is the Administrative Director of Community Impact at Inspira Health, a non-profit health system in rural, Southwestern, New Jersey. Donald earned his MPH from Liberty University. In his role as Administrative Director, Donald oversees the implementation, growth, and evaluation of numerous grant-funded programs dedicated to reducing the prevalence of cancers and chronic diseases across Cumberland, Salem, and Gloucester Counties.

These programs include the Inspira Quit Center, a tobacco cessation program, Inspira Health's ScreenNJ Lung Cancer Screening Program and NJCEED Cancer Screening Program for uninsured and underinsured community members, a cancer and chronic disease prevention coalition, a transportation program for Inspira patients that identify transportation as a barrier when seeking cancer screening and treatment services, as well as Inspira's Food Farmacy+ Programs offering food distribution and nutrition counseling to community members that identify barriers to accessing food.

**Jessica Olson, PhD***Medical College of Wisconsin*

Dr. Olson is an Associate Professor in the Institute for Health & Equity at the Medical College of Wisconsin. Her research interests are centered around disparities in breast and lung cancer, and improving maternal health outcomes. Since 2018, she has worked with the State-Based Initiatives Task Group to leverage nationwide expertise in lung cancer and address local, regional, and state-based challenges. She supports the Medical College of Wisconsin's Community and Cancer Science Network, a \$20M investment in reducing breast and lung cancer disparities in Wisconsin, and is Co-PI of ASCEND Wisconsin, a \$10M investment in improving maternal health outcomes. Both initiatives utilize transdisciplinary, equitable partnership-building between community and academic experts to address the root causes of inequities in health outcomes.

**Michael Pignone, MD, MPH***Duke Cancer Institute*

Dr. Pignone is the Professor of Medicine and Vice Chair for Quality and Innovation in the Duke Department of Medicine and the Director for Cancer Screening Equity in the Duke Cancer Institute. He holds an ACS Clinical Research Professorship. He is an expert in cancer health services research, with specific training in epidemiology and outcomes research. His long-standing research interests include: (1) improving decision-making about cancer screening, and (2) using decision modeling to inform preventive care policy, including cancer screening and prevention. He has extensive experience in developing and using modeling to support cancer-related decision-making and has developed and tested interventions to mitigate health disparities and improve the use of appropriate preventive services.

More recently, he has worked to improve the implementation of cancer screening services in vulnerable populations, along with colleagues documenting the relationship between literacy and adverse health outcomes, and also developing and testing interventions to improve self-care and increase the use of effective therapies. Dr. Pignone has published over 275 peer-reviewed journal articles and has a long history of Federal and non-Federal grant funding.

**Jeri Ramos, MA***American Cancer Society*

Ms. Ramos serves as Strategic Director of Sports Alliances at the American Cancer Society, managing league partnerships with the NBA, WNBA, and NFL. These partnerships help amplify and fund health equity initiatives like CHANGE grants that support cancer screening in under-resourced communities, The Center for Diversity in Cancer Research, and the VOICES of Black Women Study.

Prior to the American Cancer Society, Jeri held sports marketing positions for both the San Antonio Spurs and Los Angeles Sparks, developing community and corporate partnerships that generated revenue and visibility through sports and entertainment properties. Her smoking cessation campaign with the Los Angeles County Department of Public Health won a prestigious MarCom Award for its multifaceted approach in creating awareness and impact.

Jeri has a master's degree in social science and research from Bryn Mawr College in Philadelphia. She lives in San Marcos, TX where she enjoys nature, gardening, and spending time with family and friends along the spring-fed clear water of the San Marcos River.



Jennifer Redmond Knight, DrPH

University of Kentucky

Dr. Redmond Knight is a part-time Assistant Professor at the University of Kentucky College of Public Health and a member of the University of Kentucky Markey Cancer Center Cancer Control Program. In this role, she provides leadership related to quality implementation of lung cancer screening efforts (KY LEADS Collaborative™ and the QUILS™ Group), the Kentucky Cancer Consortium, practice, service, and workforce development efforts in the College of Public Health and evaluation for colorectal health systems grant. She is also a coalition coach, meeting facilitator, and strategic planner who is passionate about catalyzing diverse groups of people to work together to make a bigger impact than they could on their own.

Dr. Knight has extensive experience and interest in cancer prevention and control; coalition and partnership sustainability; policy, systems, and environmental changes; meeting facilitation, leadership, strategic planning, productivity, and focus and is currently training to be a CliftonStrengths® coach.

Dr. Knight has her BA in Communications from Ouachita Baptist University, Arkadelphia, Arkansas, MPH in Epidemiology from the University of Kentucky College of Public Health, Lexington, Kentucky, and DrPH in Health Services Management from the University of Kentucky College of Public Health.



Scout, PhD

National LGBTQI+ Cancer Network

Scout is the Executive Director of the National LGBT Cancer Network and the principal investigator of both the CDC-funded LGBTQ tobacco-related cancer disparity network and Out: The National Cancer Survey. He spends much of his time providing technical assistance for tobacco and cancer-focusing agencies expanding their reach and engagement with LGBTQ+ populations.

Scout has a long history in health policy analysis and a particular interest in expanding LGBTQ+ surveillance and research. He has faculty appointments at both Brown University and Boston Universities' Schools of Public Health. He is a new member of FDA's TPSAC, a longtime member of the NIH Council of Councils, on the Advisory Panel for NIH's All of Us initiative, and the former Co-Chair of the NIH Sexual and Gender Minority Research Office Work Group. His work has won him recognition from the U.S. House of Representatives, two state governments, and many city governments. Scout is an openly nonbinary and trans father of three, a vegetarian, an avid hiker, and climber.

**Brendon Stiles, MD***Montefiore Einstein Cancer Center*

Dr. Stiles is the Professor and Chief of Thoracic Surgery and Surgical Oncology at the Montefiore Health System and is Associate Director of Surgical Oncology for the Montefiore Einstein Cancer Center, an NCI-designated Comprehensive Cancer Center. Dr. Stiles is a clinically busy surgeon, who also leads a comprehensive translational and clinical lung cancer research program. His laboratory studies the role of extracellular mono-ADP-ribosyltransferases in cancer progression and immune regulation. Dr. Stiles is the Vice Chair of the Board of Directors of the Lung Cancer Research Foundation, Co-Chair of the AATS Foundation Advisory Council, Chair of the IASLC Communications Committee, and a member of the Lung-RADS Steering Committee.

**Jamie Studts, PhD***University of Colorado*

Dr. Studts is a Professor of Medical Oncology at the University of Colorado School of Medicine and Scientific Director of Behavioral Oncology. Dr. Studts also serves as the Co-Leader for the Cancer Prevention and Control program and Co-Director of the Population Health Shared Resource at the University of Colorado Cancer Center.

Dr. Studts is a licensed clinical health psychologist, and his interests address behavioral aspects of tobacco-related malignancies. His research develops and tests interventions to promote informed/shared decision-making and behavior change among patients and clinicians regarding prevention, screening, and survivorship of lung and head/neck cancer. His research has been funded by NCI, NIDCR, NIDA, NIEHS, the Bristol-Myers Squibb Foundation, and the Kentucky Lung Cancer Research Program. Dr. Studts is the Principal Investigator of the Kentucky LEADS Collaborative. He is a Fellow of the Society of Behavioral Medicine, a member of the Scientific Leadership Board for the GO2 Foundation for Lung Cancer, and the National Comprehensive Cancer Network's Lung Cancer Screening and Smoking Cessation Guideline Panels.

Dr. Studts serves as a member of the Steering Committee for the ACS NLCRT and as Vice Chair of the Stigma and Nihilism Task Group. In 2019 he received the Centerstone Healthcare Advocacy award in recognition of his efforts to reduce the burden of lung cancer in Kentucky.

**Thomas Varghese, Jr., MD, MS, MBA***University of Utah*

Dr. Varghese Jr. is the Chief, Section of General Thoracic Surgery at the University of Utah; Chief Value Officer (Ambulatory and Inpatient) at the Huntsman Cancer Institute (HCI); Associate Chief Medical Quality Officer at Huntsman Cancer Hospital; and a Professor (Tenure-track) in the Department of Surgery at the University of Utah School of Medicine. He is also director of HCI-Innovative Medical Practices Advancing Care Transformation (HCI-IMPACT) center that focuses on eliminating distance as a disparity for cancer care delivery in 1,200 mile Mountain West region of the US. Dr. Varghese holds national leadership positions in several major surgical societies and is the 2024-2025 President of the Society of University Surgeons (SUS). He helped launch the podcasts "Beyond the Abstract" and "Same Surgeon, Different Light" for the Society of Thoracic Surgeons (STS), and is the 2024 co-host of the Operative Word podcast for the American College of Surgeons (ACS). Dr. Varghese spends his free time with his family, as well as actively engaging on social media.



Renda Wiener, MD, MPH

VA Boston Healthcare System

Dr. Wiener is a pulmonologist, health services researcher, and implementation scientist at the Center for Healthcare Organization & Implementation Research at the VA Boston Healthcare System, a Professor of Medicine at Boston University Chobanian & Avedisian School of Medicine, and the Deputy Chief Consultant of VA's National Center for Lung Cancer Screening. Her research focuses on developing, implementing, and evaluating strategies to optimize quality, patient-centeredness, and equity of lung cancer screening, and she has been involved in developing policy and guidelines for lung cancer screening for VA and several other organizations. She serves as the Vice Chair for the ACS NLCRT Shared Decision-Making Task Group.



Chi-Fu Jeffrey Yang, MD

Massachusetts General Hospital

Dr. Yang is a thoracic surgeon at Massachusetts General Hospital and an associate professor of surgery at Harvard Medical School. Dr. Yang is focused on raising awareness of lung cancer screening. He founded the American Lung Cancer Screening Initiative, a 501(c)(3) non-profit, which has worked with communities across 50 states to highlight the importance of lung screening. He is also focused on lung cancer screening research. Currently, he is the coprincipal investigator and project leader of a \$1.5 million AHRQ R18-funded study evaluating lung cancer screening in Black women. He has senior-authored lung cancer screening research that has been published in the British Medical Journal, Journal of Clinical Oncology, and JAMA Oncology.

Dr. Yang has received numerous awards, including recognition for exceptional accomplishment in both clinical care in teaching and in community service. In 2021, he received both the Harvard Medical School Charles McCabe Faculty Prize for Excellence in Teaching and the Harvard Medical School Dean's Community Service Faculty Award. Most recently, he was awarded the 2024 Equity, Social Justice, and Advocacy Award at Harvard Medical School.

Attendees

Melinda Aldrich, PhD, MPH

Vanderbilt University Medical Center
melinda.aldrich@vumc.org

Lawrence An, MD

University of Michigan
lcan@umich.edu

John Anderson

Patient Advocate
john@serenityplanet.com

Linda Aragon, MPH

Los Angeles County Department of
Public Health
laragon@ph.lacounty.gov

Angela Barry, MA

GO2 for Lung Cancer
abarry@go2.org

Katie Bathje, MA

American Cancer Society
katie.bathje@cancer.org

Vickie Beckler, MBA, RN

AstraZeneca
Vickie.beckler@astrazeneca.com

Molly Black, MPH

American Cancer Society
molly.black@cancer.org

Andrea Borondy Kitts, MS, MPH

Rescue Lung Society
borondy@msn.com

Carla Brathwaite, MS

Radiology Health Equity Coalition
cbrathwaite@acr.org

Deborah Brown, CHES

American Lung Association
deb.brown@lung.org

Judith Burleson, MHSA

American College of Radiology
jburleson@acr.org

Kenly Burn

ACS NLCRT
kenly.burn@cancer.org

Megan Burns

American Cancer Society
megan.burns@cancer.org

Hannah Burson

ACS NLCRT
hannah.burson@cancer.org

Dwana Calhoun, MS

CDC National Network (SelfMade
Health Network/SMHN)
d.calhoun@selfmadehealth.org

**Lisa Carter-Bawa, PhD, MPH, APRN,
ANP-C**

Hackensack Meridian Health
lisa.carterbawa@hnh-cdi.org

MacKenzie Church, MPH

End Lung Cancer Now, IU Simon
Comprehensive Cancer Center
mjchurch@iu.edu

Gisoo DeCotiis, MA

Daiichi Sankyo
gdecotiis@dsi.com

Terri Ann DiJulio

Patient Advocate
Terri.Ann.DiJulio@gmail.com

Linda Dowling, RN

Lung Screening Network
linda_dowling@icloud.com

Francesca Duncan, MD, MS

University of Indiana
fcduncan@iu.edu

Debra Dyer, MD

National Jewish Health
DebraDyer1@comcast.net

Jan Eberth, PhD

Drexel University
jme336@drexel.edu

Loretta Erhunmwunsee, MD

City of Hope
lorettae@coh.org

Heather Fagan, MD, MPH

ChristianaCare
hbittner-fagan@christianacare.org

Jill Feldman

Patient Advocate
jfeld0869@gmail.com

Vickie Fowler, MD

NC ACCCC
vfowler911@gmail.com

Michelle Futrell, MSN, MBA, RN

LUNgevity
mfutrell@lungevity.org

Mary Gilarski, BSN, RN

University of Illinois Chicago
gilarski@uic.edu

Grant Greenberg, MD, MA, MHSA

Lehigh Valley Health Network
grant.greenberg@lvhn.org

Margaret Harrison, MA

Genentech
harrison.margaret@gene.com

Eric Hart, MD

Northwestern University
ehart@northwestern.edu

Nikki Hayes, MPH

Centers for Disease Control
nhayes2@cdc.gov

Louise Henderson, PhD

UNC Chapel Hill
louise_henderson@med.unc.edu

Erin Hester, PhD

University of Kentucky
erin.hester@uky.edu

Teri Hill

University of Illinois, Chicago
terihill@uic.edu

Korey Hofmann, MPH

ACS NLCRT
korey.hofmann@cancer.org

Thomas Houston, MD

AAFP
tphdoc@aol.com

Neville Irani, MD

Healthcare Quality Improvement Platform
neville@hquip.org

Hasmeena Kathuria, MD

UW-CTRI
hasmeena.kathuria@ctri.wisc.edu

Ella Kazerooni, MD, MS

University of Michigan
ellakaz@umich.edu

Kaitlyn Keen, MPH

ACS
kaitlyn.keen@cancer.org

Anita Kinney, PhD, RN

Rutgers Cancer Institute
ak1617@sph.rutgers.edu

Jennifer Knight, PhD

University of Kentucky
jennifer.knight@uky.edu

Rebecca Landy, PhD

National Institutes of Health
rebecca.landy@nih.gov

Jennifer Lewis, MD, MS, MPH

Vanderbilt University Medical Center
jennifer.a.lewis@vumc.org

Karl Lobo, MBA

Johnson & Johnson
klobo1@its.jnj.com

Eugene Manley, PhD, MS

STEMM & Cancer Health Equity Foundation
emanley@scheq.org

Christopher Martin, MPH

The David James Group
cmartin@davidjamesgroup.com

Peter Mazzone, MD, MPH

Cleveland Clinic
mazzonep@ccf.org

Timothy Merchant

RadNet
timothy.merchant@radnet.com

Morgan Miller, PharmD

Gilead
Morgan.Miller11@gilead.com

Sabrina Moffat

Advocate Health
sabrina.moffat@aah.org

Timothy Mullett, MD

University of Kentucky/Markey Cancer Center
timothy.mullett@uky.edu

Ronald Myers, DSW, PhD, FSBM

Thomas Jefferson University
ronald.myers@jefferson.edu

Heidi Nafman-Onda, MS

The White Ribbon Project
nafonda@comcast.net

Ryan Nguyen, DO

University of Illinois
rnguye8@uic.edu

Donald Noblett, MPH

Inspira Health
noblettd@ihn.org

Eduardo Nunez, MD, MS

Baystate Health
eduardo.nunez2@baystatehealth.org

Kerstin Ohlander, MPH

Ohlander Consulting
kohlander@acsconsult.com

Jessica Olson, PhD, MPH

Medical College of Wisconsin
jeolson@mcw.edu

Pierre Onda, MD, MPH

The White Ribbon Project
pierreonda@comcast.net

Elyse Park, PhD, MPH

Massachusetts General Hospital
epark@mg.harvard.edu

Michael Pignone, MD, MPH

Duke University
michael.pignone@duke.edu

Alexandra Potter

American Lung Cancer Screening Initiative
apotter8@mg.harvard.edu

Elridge Proctor, MPA

GO2 for Lung Cancer
eproctor@go2.org

Jeri Ramos, MA

American Cancer Society
jeri.ramos@cancer.org

Mary Reid, MSPH, PhD

Roswell Park Comprehensive Cancer Center
mary.reid@roswellpark.org

Dorothy Rhoades, MD, MPH

OU Health Sciences/Stephenson Cancer Center
Dorothy-Rhoades@ouhsc.edu

M. Patricia Rivera, MD

University of Rochester
patricia_rivera@urmc.rochester.edu

Albert Rizzo, MD

American Lung Association
albert.rizzo@lung.org

Lauren Rosenthal, MPH

ACS NLCRT
lauren.rosenthal@cancer.org

Susan Ruscheinsky, MSN,BSM RN

Department of Veterans Affairs
susan.ruscheinsky@va.gov

Liora Sahar, PhD, GISP

American Cancer Society
liora.sahar@cancer.org

Lori Sakoda, PhD, MPH

Kaiser Permanente Northern California
lori.sakoda@kp.org

Scout, PhD

National LGBTQI+ Cancer Network
scout@cancer-network.org

Lecia Sequist, MD, MPH

Massachusetts General Hospital
lvsequist@partners.org

Sarah Shafir, MPH

American Cancer Society
sarah.shafir@cancer.org

Keith Singer

Catch It In Time
Keith@catchitintime.org

Victoria Smith

University of Illinois Chicago
vs25@uic.edu

Stefanie Chua, PharmD

Regeneron
stefanie.chua@regeneron.com

Jody Steinhardt, MPH, CHES

NYC Health + Hospital
steinhaj1@nychhc.org

Nichelle Stigger, M.Ed.

Patient Advocate
nichellestigger@gmail.com

Brendon Stiles, MD

Montefiore Medical Center
brstiles@montefiore.org

Amy Stone, MCo

Amy Stone Scientific and Medical
Communications, Inc.
amy@scimedcomm.com

Jamie Studts, PhD

University of Colorado Cancer Center
jamie.studts@cuanschutz.edu

Shunaiber Tauhid

West Virginia Department of Health
stauhid@mcw.edu

Michael Tobin, MHA

Johnson & Johnson
MTobin2@its.jnj.com

Thomas Varghese, Jr., MD, MS, MBA

University of Utah
thomas.varghese@hsc.utah.edu

Britta Vaughan

American Cancer Society
britta.vaughan@cancer.org

Robert Volk, PhD

The University of Texas MD Anderson
Cancer Center
BVolk@mdanderson.org

Richard Wender, MD

University of Pennsylvania
richard.wender@pennmedicine.
upenn.edu

Andrew White

AstraZeneca
andrew.white2@astrazeneca.com

Renda Wiener, MD, MPH

VA National Center for Lung Cancer
Screening
renda.wiener@va.gov

Patricia Wilson, CHW

PAW Community Connections
wilsonpatricia822@gmail.com

Denise Wojcik, RN

Northwestern Memorial Hospital
Denise.wojcik@nm.org

Julie Wood, MD, MPH

American Academy of Family
Physicians
jwood@aafp.org

Chi Fu Jeffrey Yang, MD

Massachusetts General Hospital
CJYANG@MGH.HARVARD.EDU

Matthew Zoerink, MBA

AbbVie
matthew.zoerink@abbvie.com

About The American Cancer Society National Lung Cancer Roundtable

American Cancer Society Roundtable Overview

The American Cancer Society (ACS) is the leading cancer-fighting organization with a vision of ending cancer as we know it for everyone. It is the only organization working to improve the lives of people with cancer and their families through advocacy, research, and patient support. This provides the ACS with unmatched reach – able to function as a leader and convener at the national and state levels to influence public policy, engage key leaders in advancing science and evidence-based patient care, and serve as a trusted partner, communicator, and connector in our communities and with individual patients and their families. The ACS seeks to ensure that everyone has an opportunity to prevent, detect, treat, and survive cancer.

The ACS has invested in the roundtable model since 1987, when the ACS and its partners established the National Colorectal Cancer Roundtable (NCCRT). The NCCRT's 80% by 2018 campaign became one of the most effective and transformative public health cancer prevention campaigns, with over 1800 organizations making the pledge to become involved in reaching the goal of 80% screened for colorectal cancer by 2018. The follow-up campaign, 80% in Every Community, continues the initiative, with a focus on health equity and ensuring that all communities meet this goal.

The success of the ACS NCCRT laid the foundation for the establishment of the ACS National Lung Cancer Roundtable (ACS NLCRT), the ACS National Navigation Roundtable (ACS NNRT), the ACS National HPV Vaccination Roundtable (ACS NHVRT), the ACS National Breast Cancer Roundtable (ACS NBCRT), the ACS National Roundtable on Cervical Cancer (ACS NRTCC), and the ACS National Prostate Cancer Roundtable (ACS NPCRT). Each was a logical extension of prior ACS work. Before 2017, with regard to lung cancer, the ACS was instrumental in efforts to evaluate low-dose CT (LDCT) for lung cancer screening, released one of the earliest lung cancer screening guidelines, and strongly advocated for Medicare coverage for lung cancer screening.

In the 2022 President's Cancer Panel Report: Closing Gaps in Cancer Screening, (<https://prescancer-panel.cancer.gov/report/cancerscreening/Recommendations.html>), the Panel endorsed ACS roundtables. Recommendation 1.2 specifically challenged the nation to, "Expand and strengthen National Cancer Roundtables that include a focus on cancer screening," adding that, in calling for new roundtables, the Panel's Report also appealed for increased support for two existing ACS roundtables, the ACS NCCRT and ACS NLCRT, "to allow important work on colorectal and lung cancer screening to continue and expand their reach to communities with low rates of screening and follow-up care."

“The panel believes that the National Roundtable model provides an ideal framework for bringing stakeholders together and addressing gaps in cancer screening and follow-up care, including inequities experienced by various sociodemographic groups.”

– 2022 President’s Cancer Panel

The ACS has accepted the President’s Cancer Panel’s challenge, understanding that it has unique experience and capacity to build and expand roundtables, and lead critical initiatives. By the end of 2022, the ACS had launched two new roundtables – the ACS NBCRT and the ACS NRTCC, with the ACS NPCRT launching in 2024.

The goal of all ACS roundtables is the accelerated development of collaborative initiatives that would neither be feasible nor likely for any member organization to pursue alone. The ACS recognizes that many challenges warrant a comprehensive solution and a mission-oriented approach, one that must be met at both the national and local levels, and ACS roundtables offer a proven and effective platform to achieving these national goals more rapidly.

ACS National Lung Cancer Roundtable’s Work

The ACS has a strong history of improving the lives of individuals affected by lung cancer. Through research, it is currently funding 73 extramural grants that address lung cancer, totaling \$30 million. Since the 1990s, it has invested over \$29 million in research specific to lung cancer not related to tobacco – including research that found the link between the enzyme ALK and cancer, the key discovery that enabled industry researchers to develop crizotinib. The ACS was instrumental in international and U.S. efforts to evaluate LDCT for lung cancer screening and was one of the earliest organizations to release lung cancer screening guidelines. It strongly advocated for Medicare coverage for lung cancer screening when it appeared the Centers for Medicare & Medicaid Services (CMS) would not add LDCT screening to the benefits package based on concerns regarding quality. In fact, in a multi-organizational appeal to CMS, the ACS pledged to launch a new national roundtable focused on promoting best practices in lung cancer screening.

Since 2017, the ACS NLCRT has galvanized public, private, and government member organizations and leading experts, as well as patient and caregiver advocate representatives, to collectively address and problem-solve the challenges around lung cancer. While originally envisioned as having a focus on lung cancer screening, the early recommendations of its Steering Committee led the ACS NLCRT to broaden its scope to include the entire lung cancer continuum and to include industry partners in its mission. Through a multidimensional and multisectoral approach, the ACS NLCRT engages these experts and organizations in all areas to catalyze action to conceive, build, and strengthen innovative solutions.

After seven years of dedicated work, the ACS NLCRT has reached a point of maturity where ongoing research and design has produced valuable tools, publications, and initiatives. Our wide-ranging membership allows us to harness the collective power and expertise of the entire lung cancer community by connecting leaders, communities, and systems to improve equity and access. These relationships, both national and local, provide immediate partnerships and dissemination outlets for these tools and resources.

The ACS NLCRT's scope of work is comprehensive and covers the lung cancer continuum – from risk reduction, tobacco prevention and control, early detection (screening and incidental lung nodule management), and guideline-based staging, biomarker testing, and treatment to survivorship, including overarching issues such as stigma and nihilism and health equity, to tactical approaches including state coalition efforts and policy initiatives. These themes fall under 3 strategic priorities and 1 cross-cutting priority. These priorities allow us to advance lung cancer-related best practices and health equity by identifying and working to overcome barriers to quality care and equitable access to care. More information about the ACS NLCRT and its current work can be found at www.NLCRT.org.

ACS NLCRT Strategic Priorities

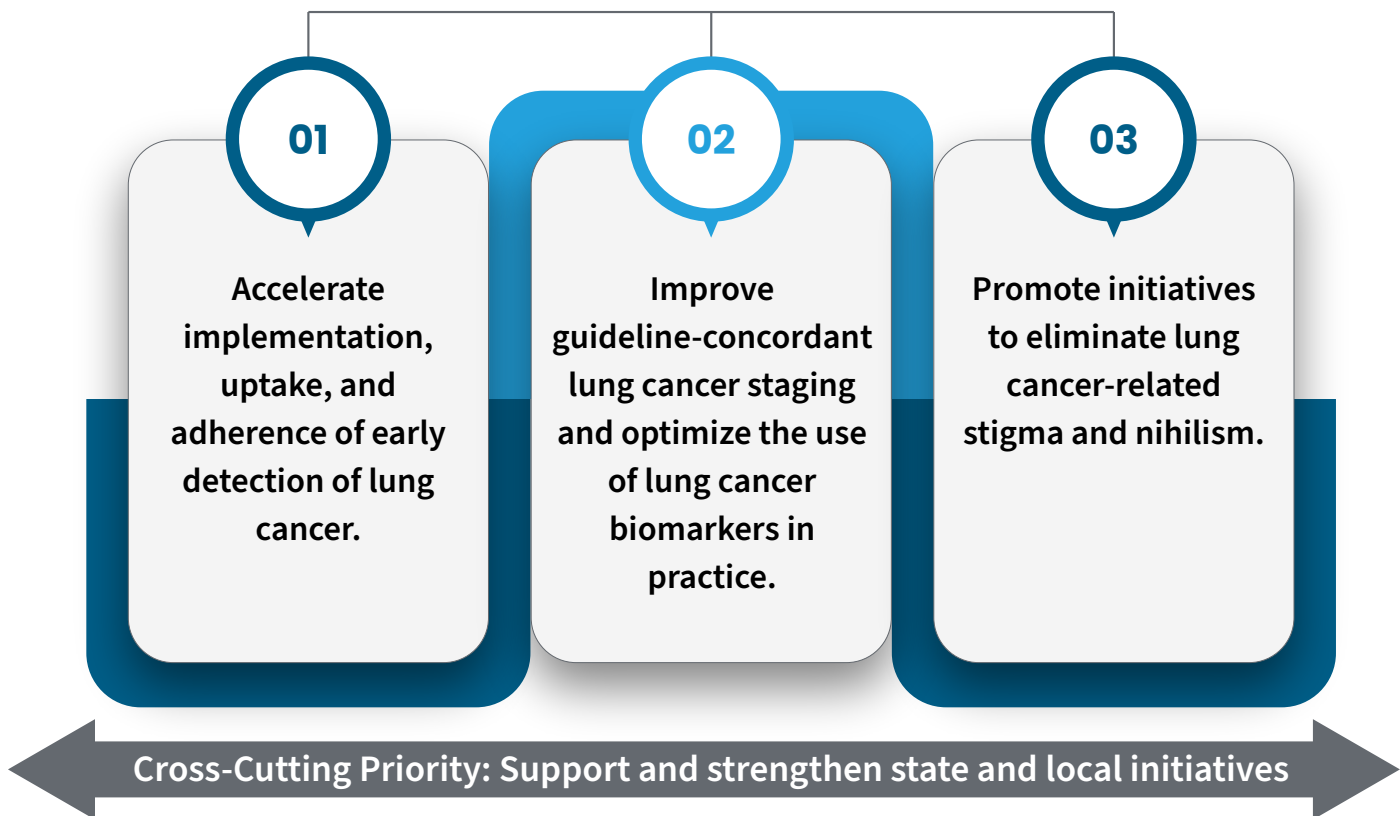



Please Join Us—The American Cancer Society National Lung Cancer Roundtable (ACS NLCRT), GO2 for Lung Cancer (GO2), Radiology Health Equity Coalition (RHEC), and American College of Radiology (ACR) have partnered once again for the **third annual National Lung Cancer Screening Day (“National LCS Day”)** on **Saturday, November 9, 2024**. In addition, we are once again partnering with the Veterans Health Administration to promote this event to veterans and their families throughout the month of November.

To participate, lung cancer screening centers nationwide are being encouraged to open their doors to patients on Saturday, November 9, 2024. This will allow individuals who cannot take time off from work to be screened, increasing the accessibility of lung cancer screening overall. Through the promotion of National LCS Day, screening centers are not only extending screening opportunities to those who may be unaware of this effective, lifesaving screening option but also are increasing the awareness of lung cancer screening within their community.

National LCS Day is meant to serve as a catalyst for screening in general. Rather than waiting until November to work lung screening into their routine, patients and clinicians alike are encouraged to make screening a year-round priority. Please join the lung cancer community for National LCS Day on Saturday, November 9, 2024.



For more information, scan the QR code above to visit the official National LCS Day website.

Save the Date!

2024 ACS NLCRT Annual Meeting



Mark your calendars for December 9-10, when the ACS NLCRT will host its 8th Annual Meeting in Atlanta, Georgia at the Omni Centennial Park Hotel. Along with a new venue, we are planning several new additions to the program, making the 2024 Annual Meeting the ACS NLCRT's best conference yet. We are pleased to announce our two keynote speakers for this meeting, **Chris T. Pernell, MD, MPH, FACPM**, and **Pasi A. Jänne, MD, PhD**.



Chris T. Pernell, MD, MPH, FACPM, serves as the Director of the NAACP Center for Health Equity. Prior to joining the nation's oldest and most venerable civil rights organization, she launched The Esther Group, a public health consulting and health equity strategy firm. As founder of The Esther Group, she lives the mandate to dare a future where organizations, communities and systems can innovate for a better world and humanity.

Director of the Lowe Center for Thoracic Oncology at the Dana-Farber Cancer Institute and professor at Harvard Medical School, **Pasi A. Jänne, MD, PhD**, will provide a keynote presentation, anchoring a panel session on the current lung cancer treatment landscape. Dr. Jänne was a co-discoverer of epidermal growth factor receptor (EGFR) mutations and has led the development of therapeutic strategies for patients with EGFR-mutant lung cancer.



Additional updates to the Annual Meeting can be found on the NLCRT website, and in upcoming newsletters, with registration opening in early September. We hope to see you there!



NATIONAL
LUNG CANCER
ROUNDTABLE